



AMT-AC Curved blades ceiling grilles

The **AMT-AC** series grilles are designed for air supply in HVAC facilities.

- Single deflection grilles.
- False ceiling mounting.
- Available for air supply in 1 or 2 ways.
- Individually adjustable curved blades.

Product Advantages:

- Adjustment of the throw and direction of the air stream in 1 or 2 ways.
- Large air volume capacity.
- Perimeter gasket for sealing with the wall or ceiling.
- Opposed blades damper in black color for better aesthetics.



- Residential
- Offices

AMT-AC

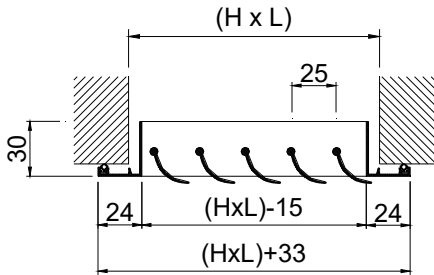

AMT-ACO

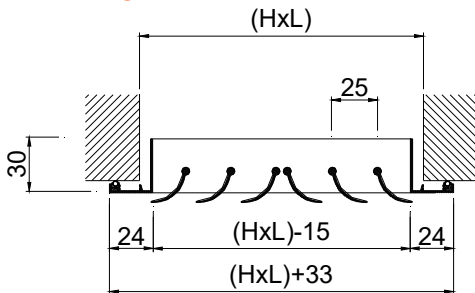

AMT-AC + SP

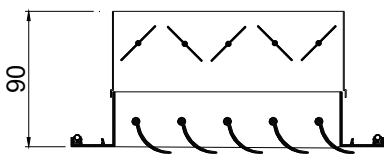

CLASSIFICATION

AMT-AC One-Way grille with blades parallels to the largest side (L size)

AMT-ACO Two-Way grille with blades parallels to the largest side (L size)

BMT-AC One-Way grille with blades parallels to the shortest side (H size)

BMT-ACO Two-Way grille with blades parallels to the shortest side (H size)

MATERIAL

Extruded aluminium grilles. All the grilles are provided with a seal on the back of the frame in order that the perimeter in contact with ceilings is airtight.

ACCESSORIES

CM Mounting frame constructed from galvanized steel. It is delivered in 4 linear elements to assemble. The opening dimension LxH must be increased by 8 mm.

SP Opposed blades damper to regulate the air flow. The damper is operated by an easily accessible key inside the grille. Constructed from zinc plated steel in black colour.

PLRO/S/

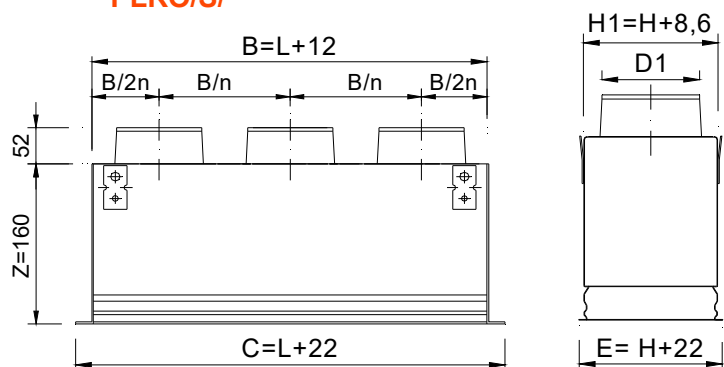

PLRO /L/

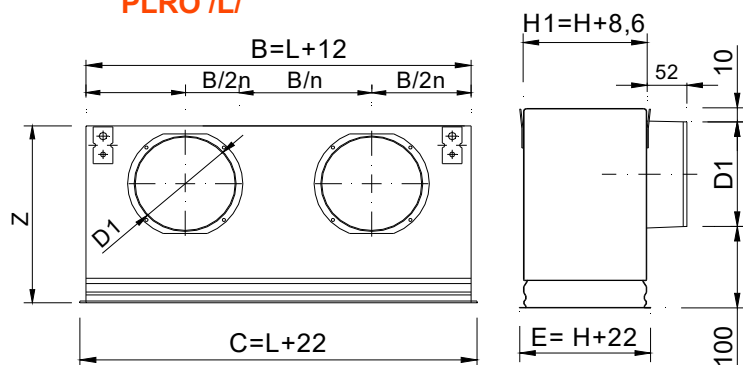

ACCESSORIES – PLENUM BOX

PLRO Plenum box with circular connection, made from galvanized steel. Suitable for both wall and ceiling mounting.

.../S/ Upper circular connection.

.../L/ Lateral circular connection.

...-R Damper in the spigot.

.../AIS/ Plenum box with thermal insulation inside.

Foam density 25 kg / m³ ISO 845. Thermal conductivity 10° C_0,040 W / m°K EN 12667.

Classified reaction to fire B-s1, d0 EN 13501-1.

PLRO/S/ (D1)

LxH	100	150	200	250	300
200	1/98	1/123	1/198		
250	1/98	1/123	1/198	1/198	
300	1/98	1/123	1/198	1/248	1/248
350	1/98	1/123	1/198	1/248	1/248
400	1/98	1/123	1/198	1/248	1/248
450	1/98	1/123	1/198	1/248	1/248
500	1/98	1/123	1/198	1/248	1/248
600	2/98	2/123	1/198	1/248	1/248
700	2/98	2/123	1/198	1/248	1/248
800	2/98	2/123	1/198	1/248	1/248
900	2/98	2/123	2/198	1/248	1/248
1000	2/98	2/123	2/198	1/248	2/248

PLRO/L/ (D1)

LxH	100	150	200	250	300
200	1/123	1/158	1/198		
250	1/123	1/198	1/198	1/198	
300	1/158	1/198	1/198	1/198	1/248
350	1/158	1/198	1/198	1/248	1/248
400	1/158	1/198	1/248	1/248	1/248
450	1/198	1/198	1/248	1/248	1/313
500	1/198	1/198	1/248	1/248	1/313
600	1/198	2/198	1/248	1/248	1/313
700	2/198	2/198	2/198	2/248	2/248
800	2/198	2/198	2/198	2/248	2/248
900	2/198	2/198	2/248	2/248	2/313
1000	2/198	2/198	2/248	2/248	2/313



(O)

(H+8) x (L+8)

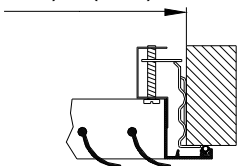

FIXING SYSTEMS

(O) The grille is fixed in place by a hidden screw. Advisable for ceiling mounting. It requires CM mounting frame or PLRO plenum box.

(T) The grille is fixed in place with visible screws.

(T)

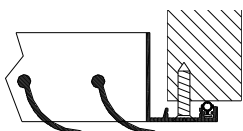

FINISHES

AA Matt silver anodized.

M9016 Pre-lacquered white similar to RAL 9016 (85-95% gloss)

SPECIFICATION TEXT

Supply and mounting of grille in One-Way for air supply with individually adjustable curved blades parallels to the largest side series

AMT-AC+SP+CM (O) M9016 dim. LxH, constructed from aluminium pre-lacquered white similar to RAL 9016 (85-95% gloss) with opposed blades volume damper from zinc plated steel in black colour, invisible fixing by hidden screws and mounting frame. Manufacturer **MADEL**.



AMT-AC series

FREE FACE AREA m2.

H \ L	150	200	250	300	350	400	450	500	600	700	800	900	1000
100	0,004	0,006	0,008	0,01	0,012	0,013	0,015	0,017	0,020	0,023	0,027	0,03	0,034
150	0,007	0,01	0,013	0,016	0,019	0,021	0,024	0,027	0,032	0,038	0,043	0,048	0,054
200	0,01	0,014	0,018	0,022	0,025	0,029	0,033	0,037	0,044	0,052	0,059	0,066	0,074
250	0,013	0,018	0,023	0,027	0,032	0,037	0,042	0,047	0,056	0,066	0,075	0,084	0,094
300	0,016	0,021	0,027	0,033	0,039	0,045	0,051	0,059	0,070	0,082	0,094	0,106	0,118
350	0,018	0,025	0,032	0,039	0,046	0,053	0,06	0,067	0,080	0,094	0,107	0,12	0,134
400	0,021	0,029	0,037	0,045	0,053	0,061	0,069	0,077	0,092	0,108	0,123	0,138	0,154
450	0,024	0,033	0,042	0,051	0,06	0,069	0,078	0,087	0,104	0,122	0,139	0,156	0,174

FREE VELOCITY, PRESSURE LOSS AND SOUND POWER LEVEL.

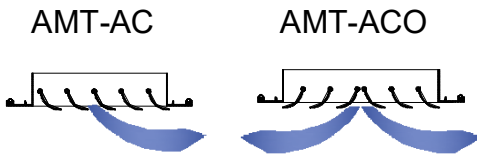

RECOMMENDED VELOCITY.

Vmin m/s	Vmax m/s
2	3.5

Determination of air flow.

Measuring the Vf in different points of the grille, we find the Vfmed.

$$Q \text{ (l/s)} = V_{fmed} \text{ (m/s)} * A_{free} \text{ (m}^2\text{)} * 1000$$

$$Q \text{ (m}^3\text{/h)} = V_{fmed} \text{ (m/s)} * A_{free} \text{ (m}^2\text{)} * 3600$$

CORRECTION FACTOR FOR Lwa1.

Afree m2	0,01	0,02	0,05	0,1	0,2
Lwa1(kf)	-9	-6	-3	-	+4

Weighted noise level related to

Afree = 0,1m2.

$$Lwa = Lwa1 + Kf$$

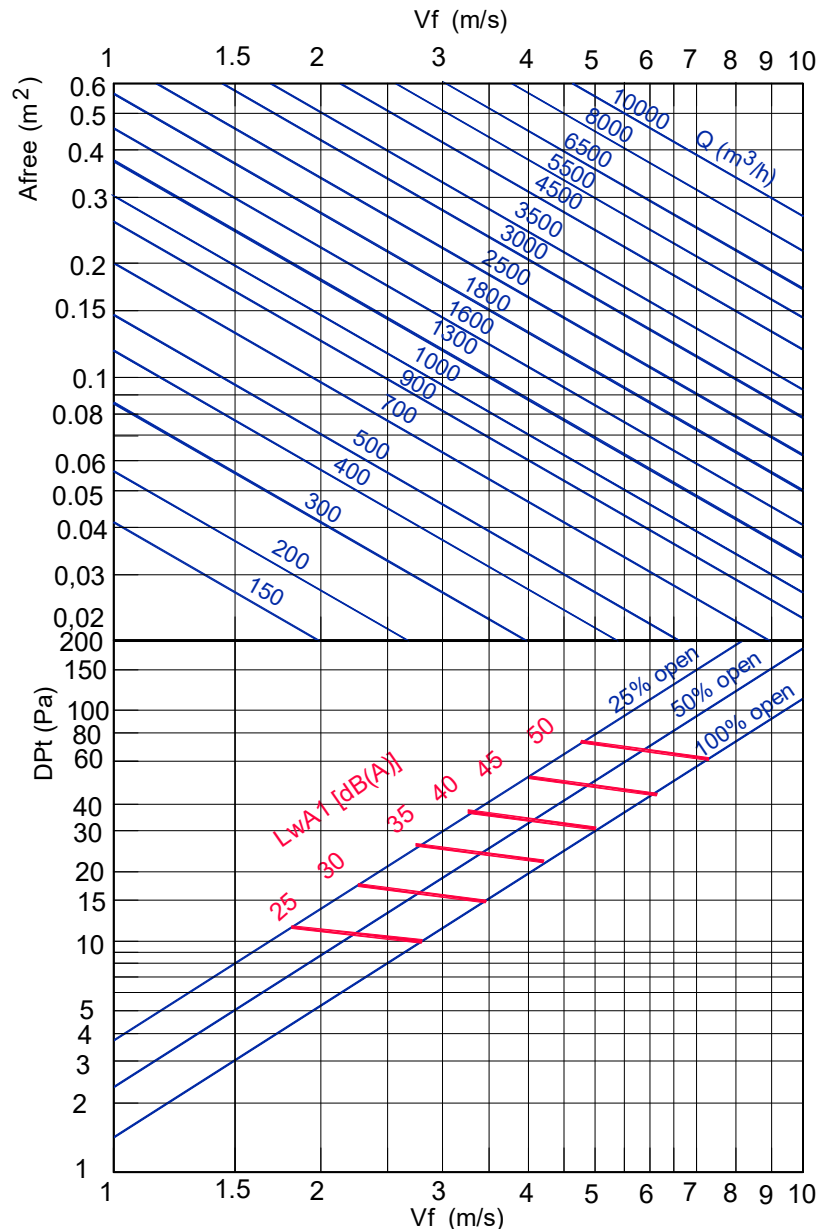

Note: In MadelMedia Octava band centre frequency in Hz.

