



BWC ventilation valves

BWC series valves are designed for the air supply or air exhaust in HVAC installations.

Especially suitable for air exhaustion in washrooms and for ventilation installation in housings, offices, schools and hospitals .

It is mounted in walls or false ceilings. **BWC** valves allow a high airflow pass obtaining good results in sound pressure performance. Flow is easily adjusted by turning the center part of the valve.



BWC-N

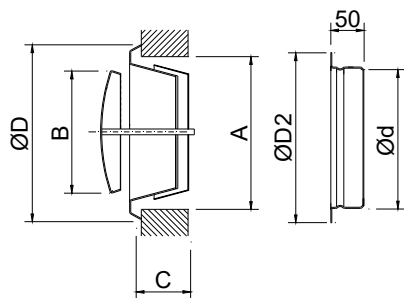

Ø	A	B	C	Ød	ØD2	ØD
BWC-N-100	104	75	40	99	123	138
BWC-N-125	129	100	46	124	148	164
BWC-N-160	169	130	54	159	184	211
BWC-N-200	209	158	64	199	227	248

BWC-S

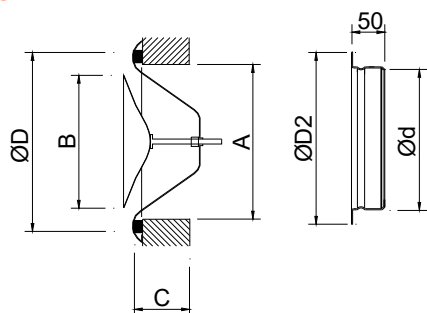

Ø	A	B	C	Ød	ØD2	ØD
BWC-S-100	104	75	40	99	122	140
BWC-S-125	129	99	46	124	148	170
BWC-S-150	154	99	54	149	175	202
BWC-S-160	169	119	54	159	184	202
BWC-S-200	209	157	64	199	225	254

BWC-C

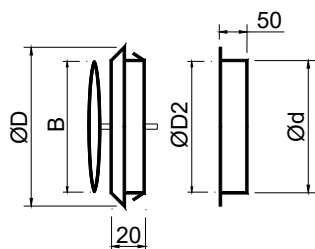

DIAM	ØD	Ød	ØD2	B
BWC-C-100	148	100	80	86
BWC-C-125	168	125	100	106
BWC-C-150	186	150	120	130
BWC-C-200	240	200	170	178

CLASSIFICATION

BWC-N Extract valve made from galvanised steel.

BWC-S Supply valve made from galvanised steel.

BWC-C Extract or supply valve made from white polypropylene.

MATERIAL

All the valves are provided with a seal on the back of the frame in order that the perimeter on contact with the ceiling is airtight.

FIXING SYSTEMS

1) The fastening of the valves is carried out by means of clips. Each valve has its own mounting neck.

FINISHES

R9010 Lacquer in white colour RAL9010.

BWC-C White polypropylene..

SPECIFICATION TEXT

Supply and mounting of circular valve with adjustable core for extract or air supply with mounting neck series **BWC-N R9010 dim. 100** constructed from galvanised steel paint in white **RAL 9010**, invisible fixing by clips and mounting neck.

Manufacturer **MADEL**.

BWC-N & BWC-C

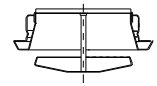

FREE FACE AREA (m2)

BWC	Qmin. m3/h	Qmax. m3/h
100	10	150
125	20	220
150	20	250
160	20	280
200	30	440

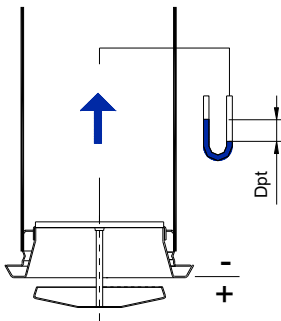

PRESSURE LOSS AND SOUND POWER LEVEL.

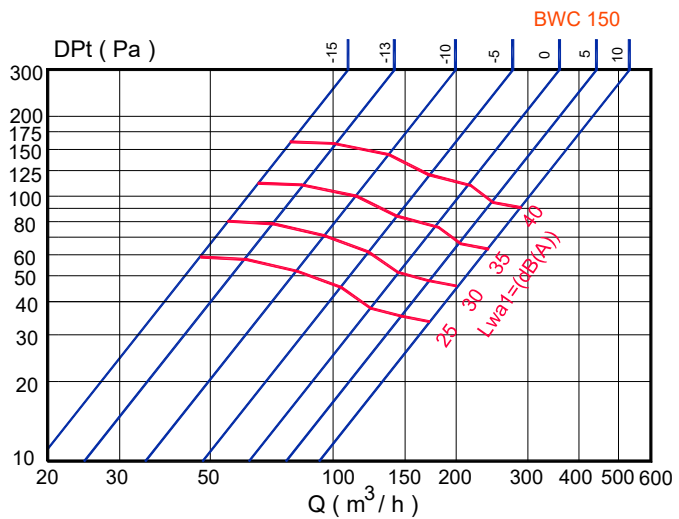
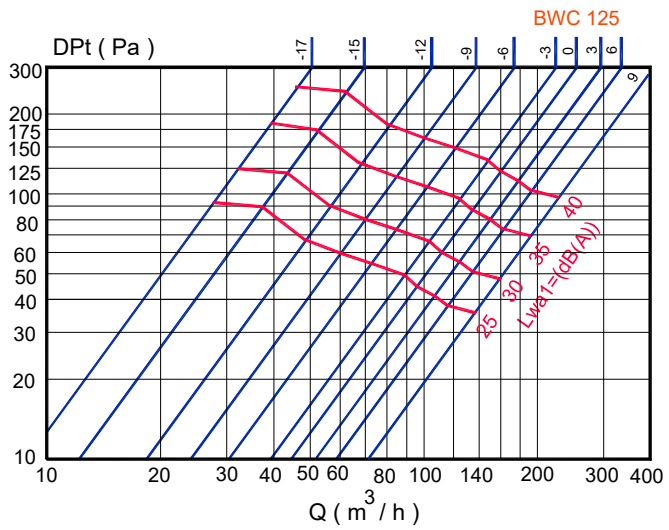
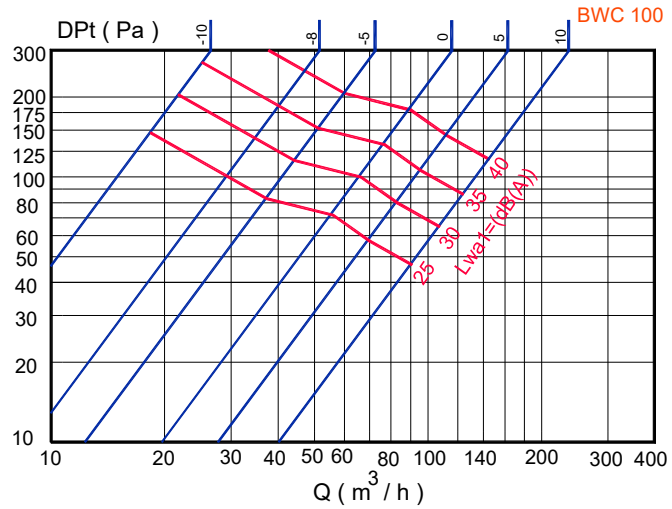

BWC-N & BWC-C

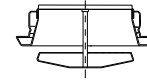

PRESSURE LOSS AND SOUND POWER LEVEL.

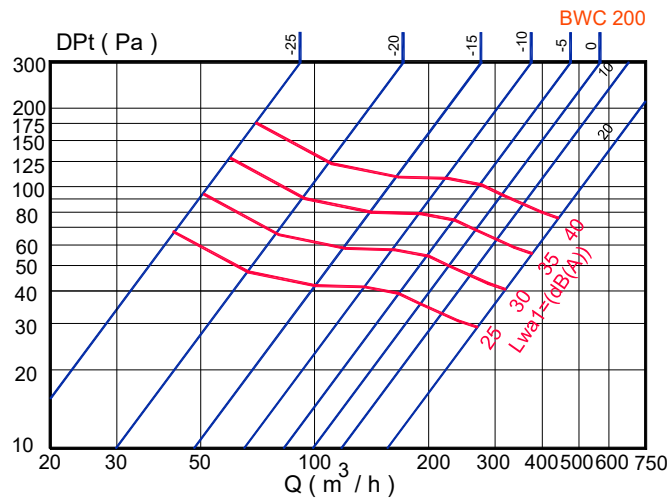
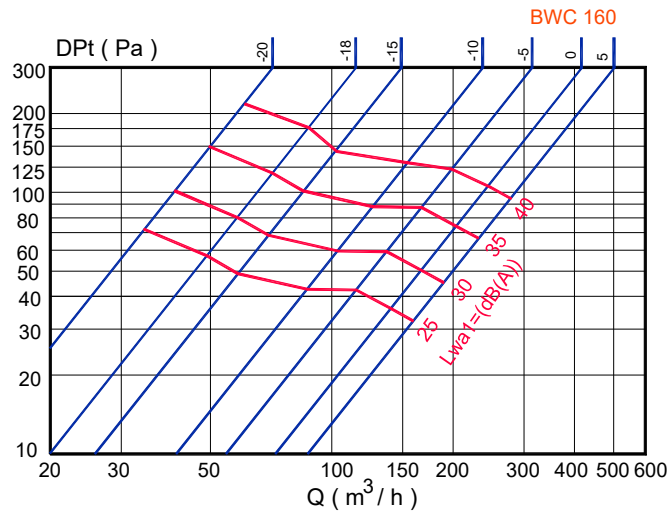

BWC-S

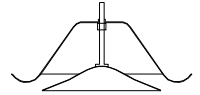

FREE FACE AREA (m²)

BWC-S	Qmin. m ³ /h	Qmax. m ³ /h
100	50	72
125	72	108
160	180	234
200	288	432

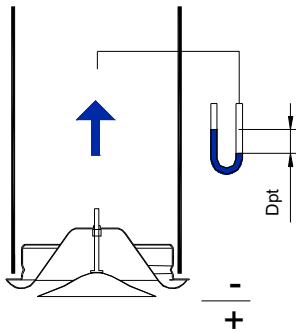

PRESSURE LOSS AND SOUND POWER LEVEL AND ISOTHERM THROW

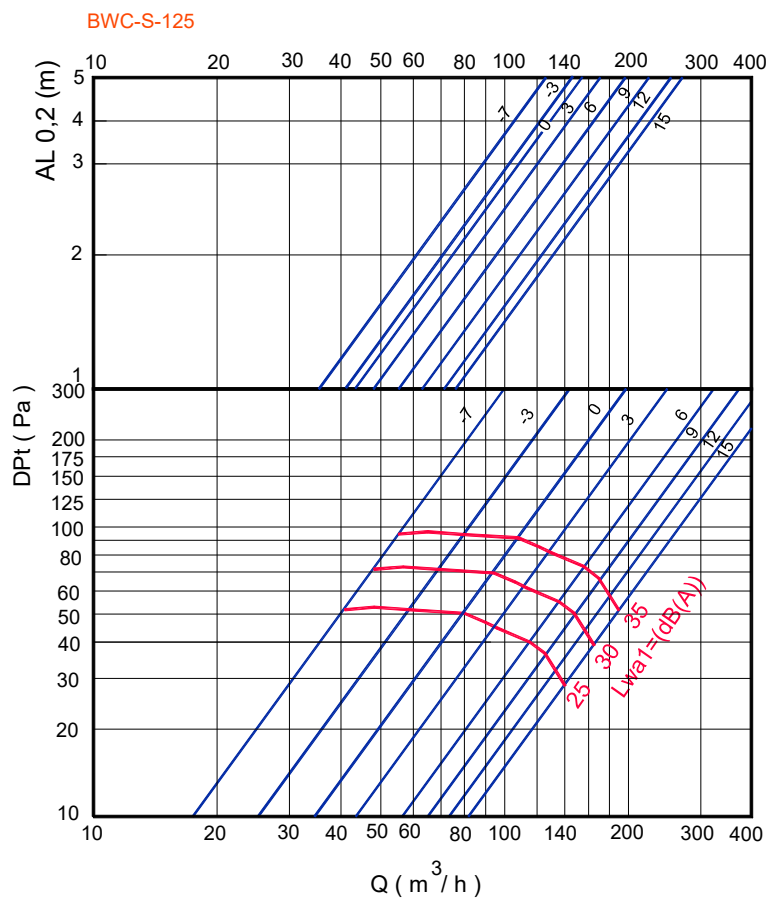
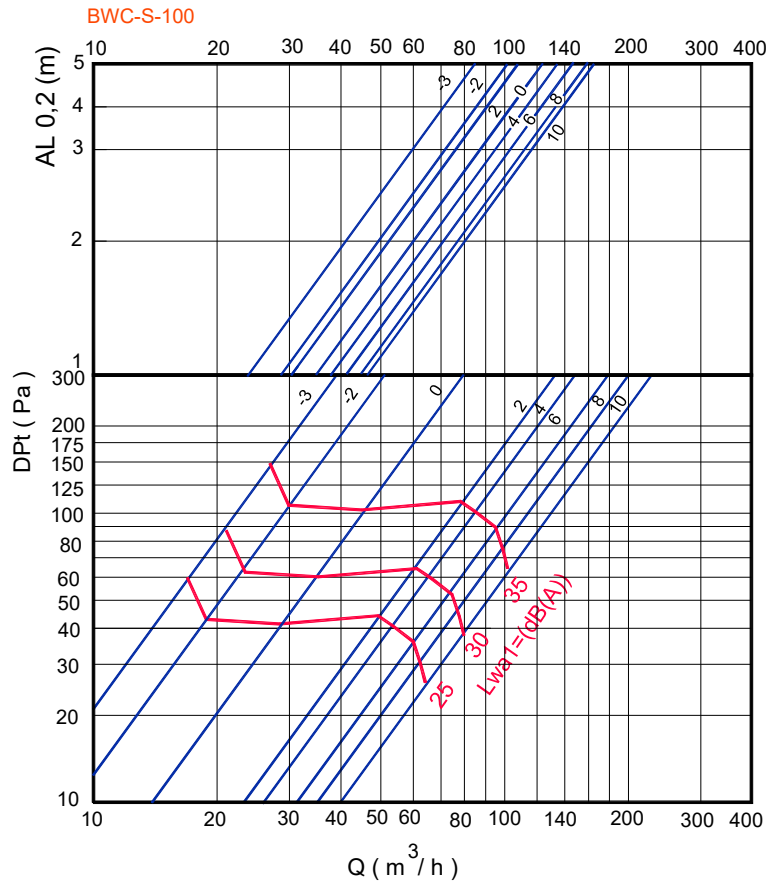

BWC-S

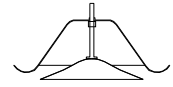

PRESSURE LOSS AND SOUND POWER LEVEL AND ISOTHER THROW

BWC-S-160

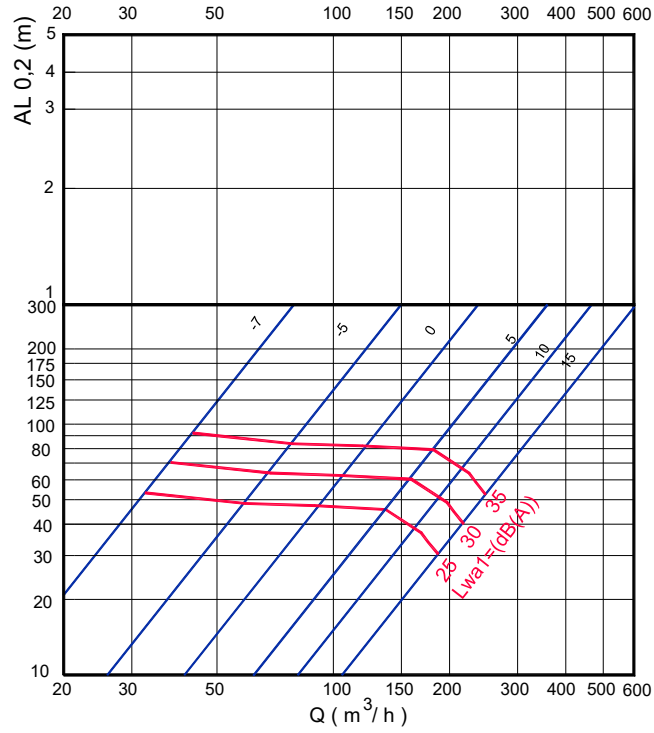

BWC-S-200

